

Rev.	Description	Date
01	Release for Production	08/24/2012

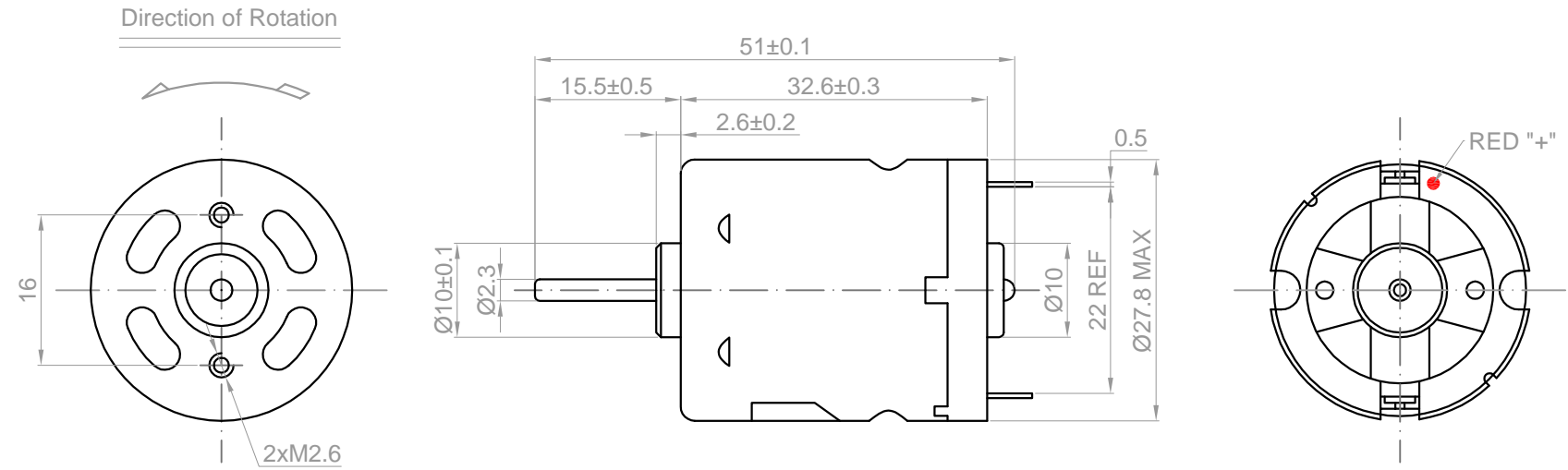

NO.	Item	Specification	NO.	Item	Specification
1	Rated Voltage	12.0 V DC	7	No Load Current	0.30 A Max
2	Rated Torque	52.08 g.cm	8	No Load Speed	15500±10% RPM
3	Rated Current	≤1.3 A	9	Starting Voltage	≤0.8V
4	Rated Speed	12586±10% RPM	10	Insulation Resistance	≥10.0 MΩ
5	Output Power	6.73 W	11	Stall Torque	285 g.cm
6	Max Efficiency	62.7%	12	Stall Current	4 A

Drawn	Feny	08/24/2012
Checked	Sara	08/24/2012
Eng Appr.		
Mfg Appr.		
Q.A.		
P/N	232040	

<h1>Sinotech</h1>		
Scale: 3:1		Sheet 1 of 1